



PVE Control Head

Mounting Instructions

Content

PVE 0 - NO for 1" Valve size.....	2
PVE 0 - NC for 1" Valve size.....	4
PVE 1 - NO for 1.5"&2" Valve size.....	6
PVE 1 - NC for 1.5"&2" Valve size.....	8
PVE 2 - NO for 2.5"&3" Valve size.....	10
PVE 2 - NC for 2.5"&3" Valve size.....	12
PVE 3 - NO for 4" Valve size.....	14
PVE 3 - NC for 4" Valve size.....	16
PVE Control head wire diagram.....	18

PVE 0 - NO

Parts List

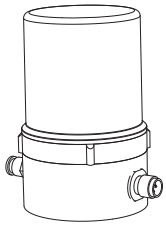

Control head
x1

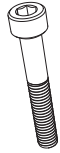

M6X40mm
x2



o-ring 2X60
x1



Magnet switch
actuator rod
x1



Swivel 90 Deg. Elbow
adaptor 6XG1/8BSPP
x1



Pressure air
line
x1



Swivel 90 Deg. Elbow
adaptor 6XR1/8BSPT
x1

1. Unscrew main shaft cover (manually) and four M6 screws (with 10 mm wrench) of the actuator's plastic cover (control head side). Remove the plastic cover.

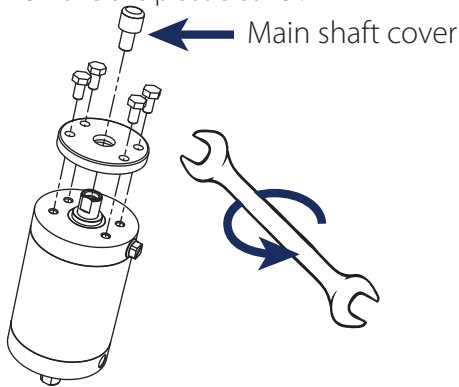

2. Insure that the plastic bushing step is forwarding the control head side.

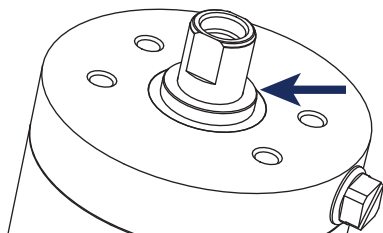

3. Unscrew manually plastic cover of control head.

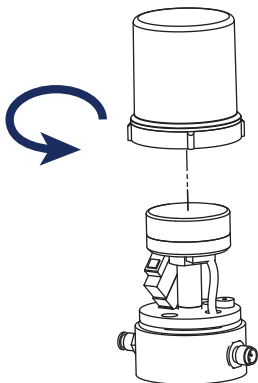

4. Insert M6 screws in control head holes.

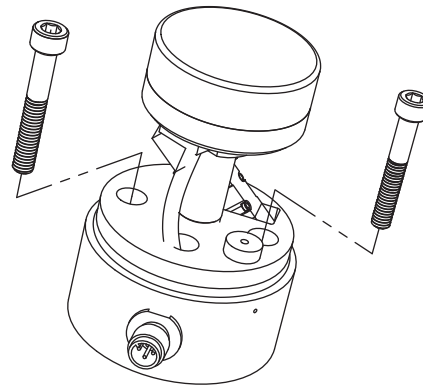

5. Screw down manually the magnet switch actuator stem to the actuator rod.

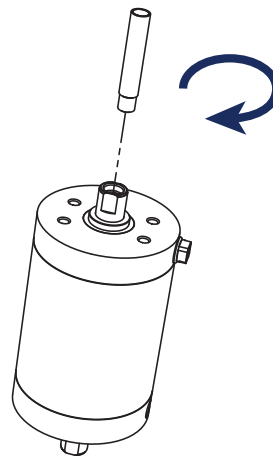

- 6.** Connect the control head to the actuator: Screw down the two M6 screws (with Hex key #5. Closure torque $T=2.0$ [Nm]) through the actuator, ensure O-ring 2x60 is in slot between control head and actuator.
See configuration on section #10.

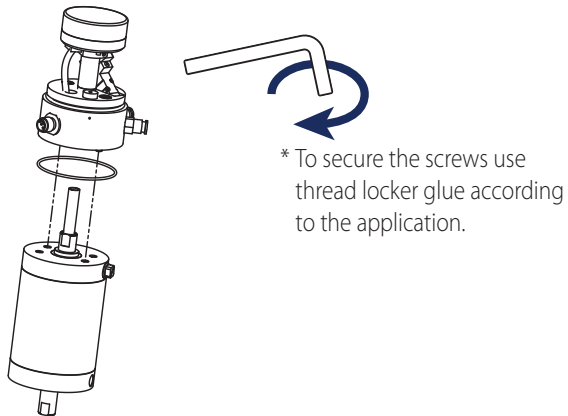

- 7.** Connect air connections and electrical connection according to configuration on section #10

- 8.** Press control head calibration button for 3 second, until the control head will start automatic calibration procedure.

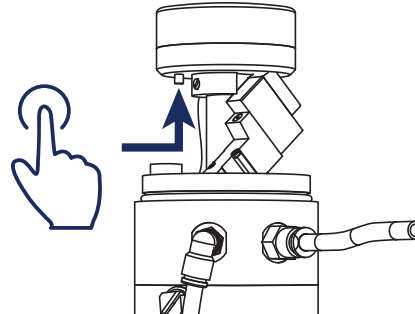

- 9.** Screw down manually the plastic cover of control head.

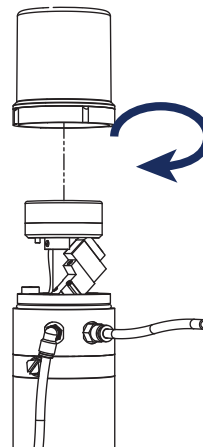

10. Connecting configurations

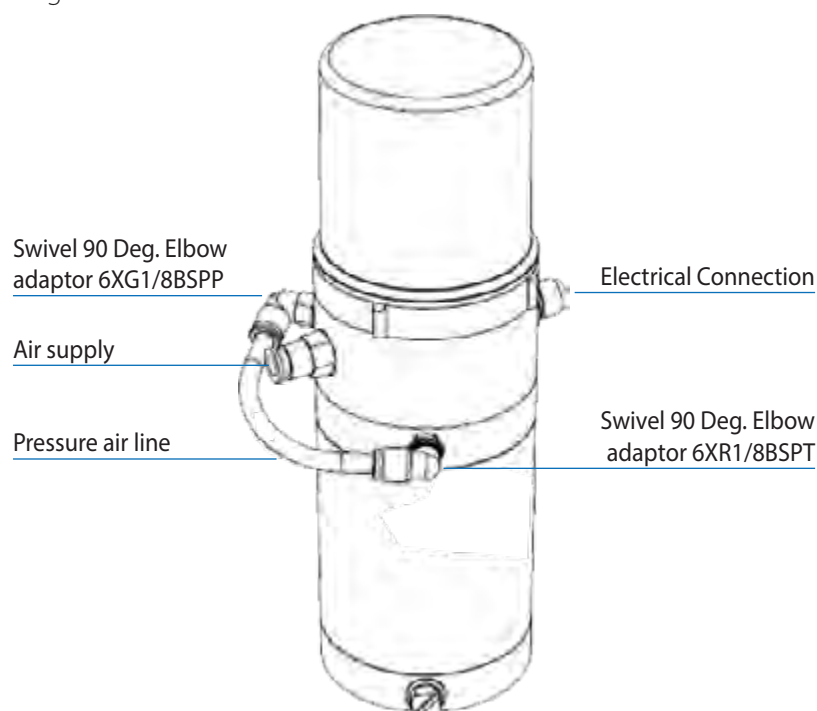

PVE 0 - NC

Parts List

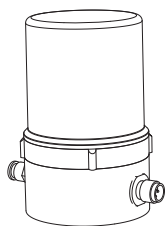

Control head
x1

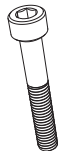

M6X40mm
x2



o-ring 2X60
x1



Magnet switch
actuator rod
x1



Swivel 90 Deg. Elbow
adaptor 6XG1/8BSPP
x1



Pressure air
line
x1



Swivel 90 Deg. Elbow
adaptor 6XR1/8BSPT
x1

1. Unscrew main shaft cover (manually) and four M6 screws (with 10 mm wrench) of the actuator's plastic cover (control head side). Remove the plastic cover.

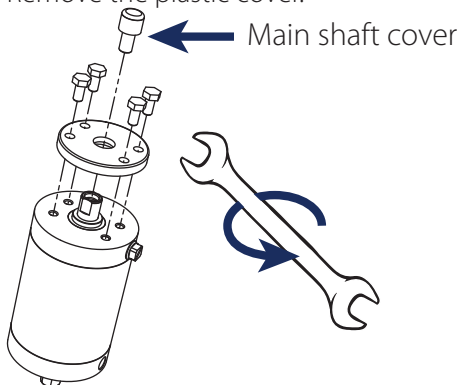

2. Insure that the plastic bushing step is forwarding the control head side.

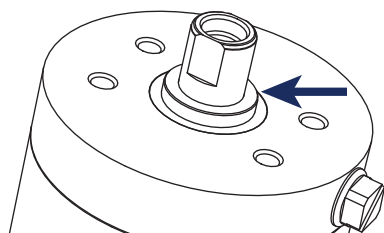

3. Unscrew manually plastic cover of control head.

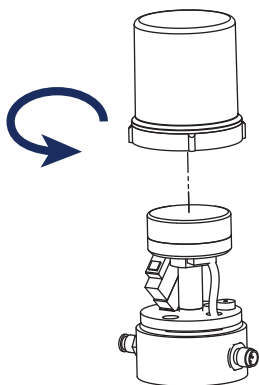

4. Insert M6 screws in control head holes.

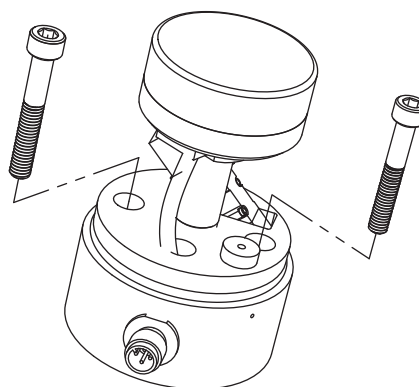

5. Screw down manually the magnet switch actuator stem to the actuator rod.

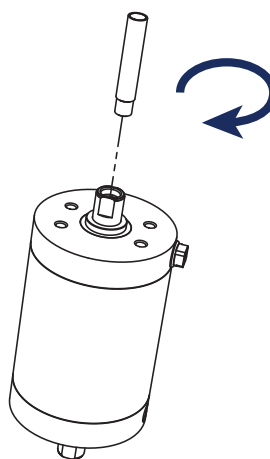

- 6.** Connect the control head to the actuator : Screw down the two M6 screws (with Hex key #5. Closure torque $T=2.0$ [Nm]) through the actuator, ensure O-ring 2x60 is in slot between control head and actuator.
See configuration on section #10.

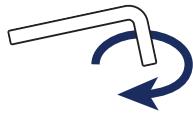
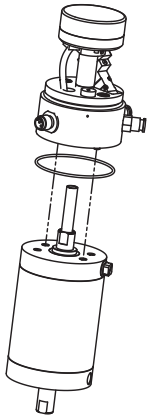

* To secure the screws use thread locker glue according to the application.

- 7.** Connect air connections and electrical connection according to configuration on section #10

- 8.** Press control head calibration button for 3 second, until the control head will start automatic calibration procedure.

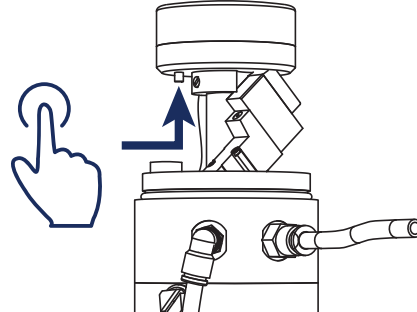

- 9.** Screw down manually the plastic cover of control head.

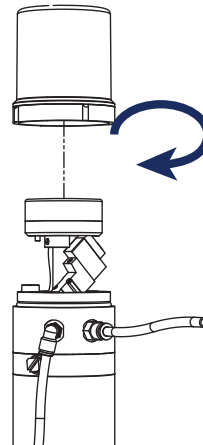

10. Connecting configurations

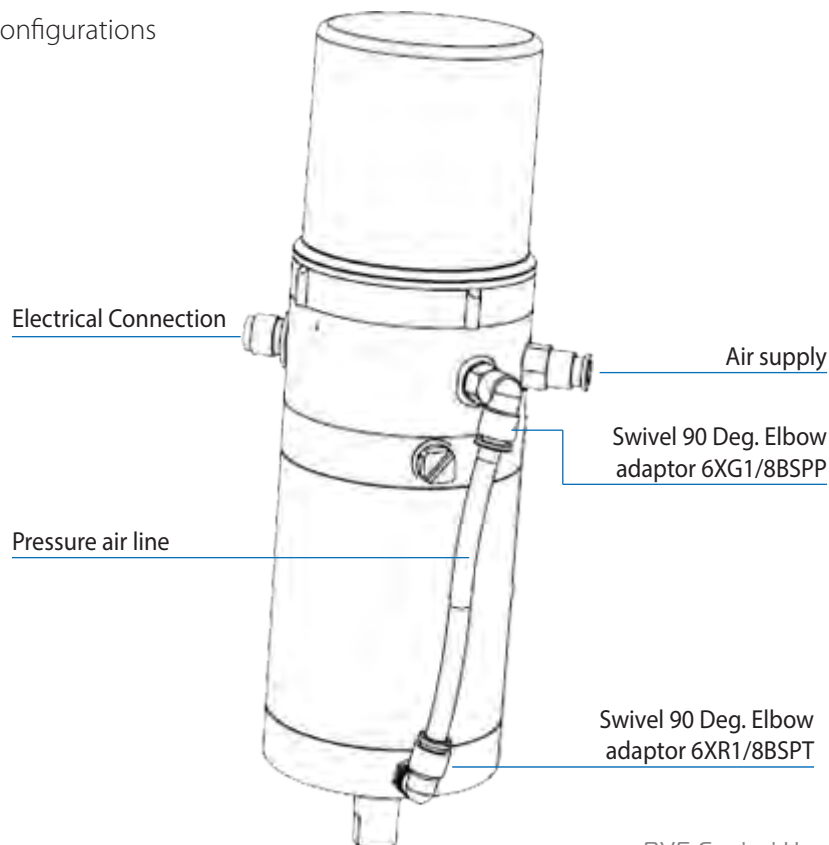

PVE 1 - NO

Parts List

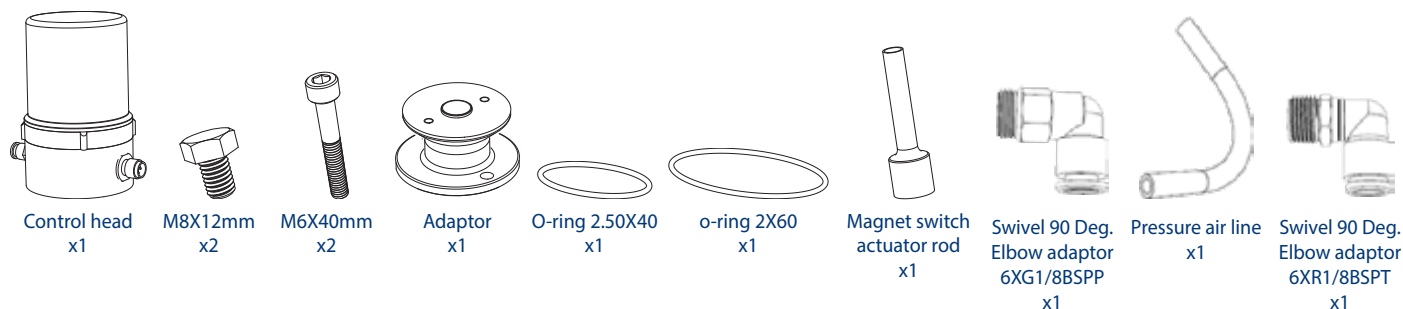

1. Unscrew main shaft cover (with slot screwdriver) and two flat head M8 screws (with Hex key #5) of the actuator's plastic cover (control head side). Remove the plastic cover

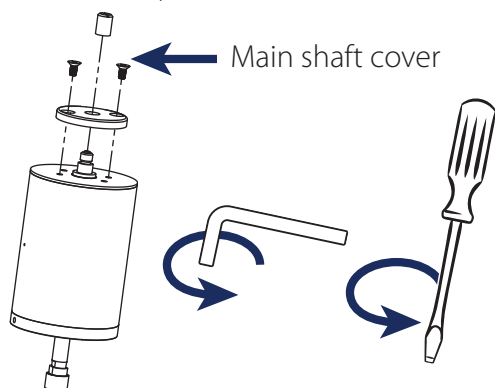

2. Insure that the plastic bushing step is forwarding the control head side.

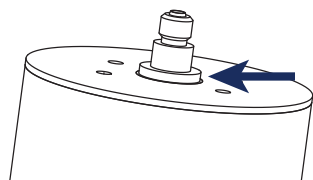

3. Unscrew manually plastic cover of control head.

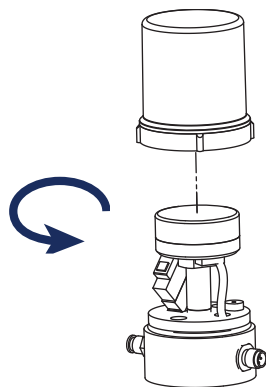

4. Insert M6 screws in control head holes.

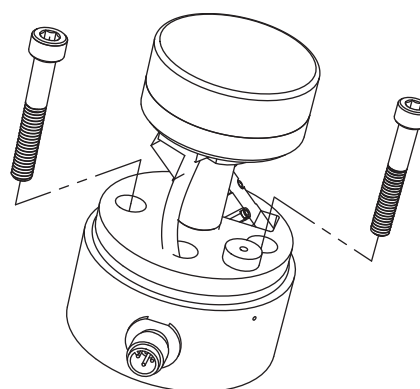

5. Screw down the two M6 screws (with Hex key #5. Closure torque $T=2.0$ [Nm] max.) through the adaptor, ensure O-ring 2x60 is in slot between control head and adaptor.

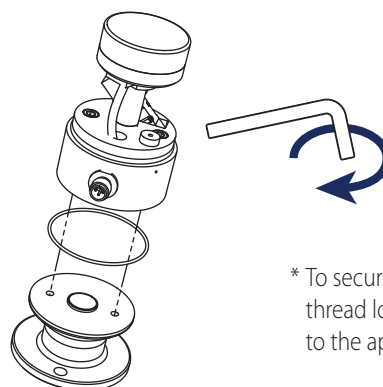

6. Screw down manually the magnet switch actuator rod to the actuator rod.

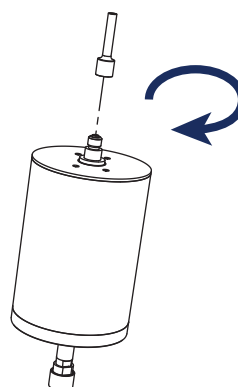

- 7.** Connect control head adaptor to the actuator with two M8 screws. Ensure O-ring 1.78x34.65 is in slot between adaptor and actuator. See configuration on section #12.

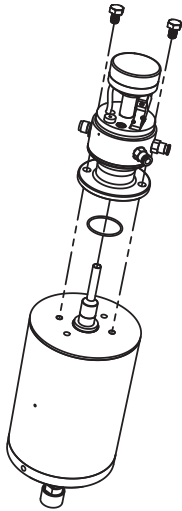

- 8.** Close the M8 screws with 13 mm Wrench Closure torque $T=4.5$ [Nm].

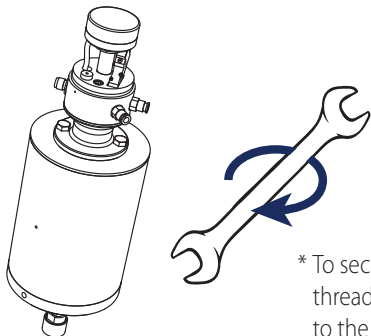

* To secure the screws use thread locker glue according to the application.

- 9.** Connect air connections and electrical connection according to configuration on section #12.
- 10.** Press control head calibration button for 3 second, until the Control Head will start automatic calibration procedure.

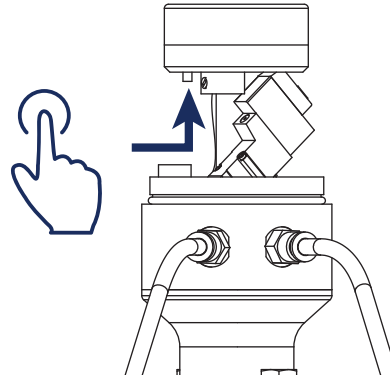

- 11.** Screw down manually the plastic cover of control head.

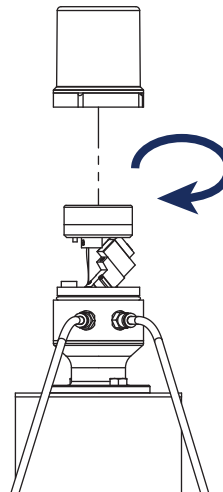

12. Connecting configurations

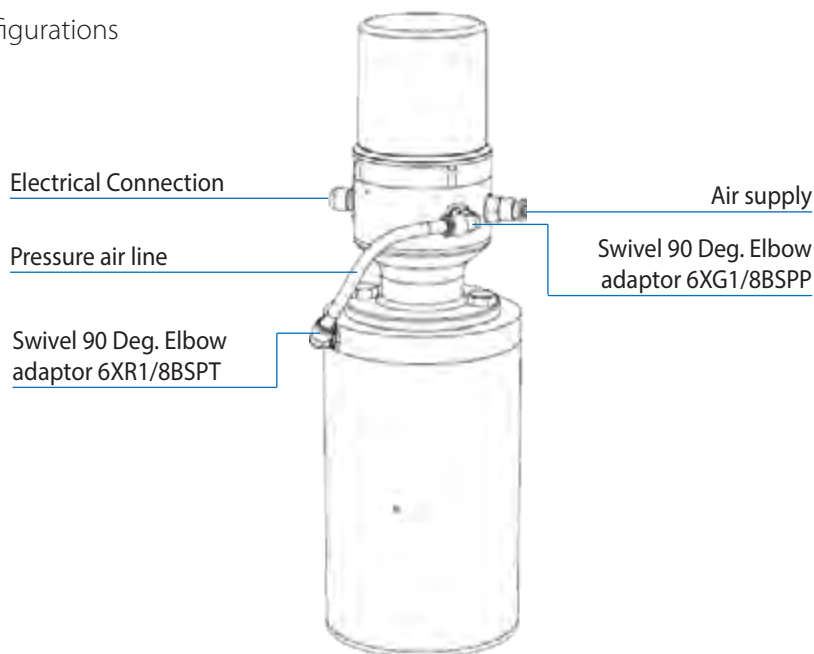

PVE 1 - NC

Parts List

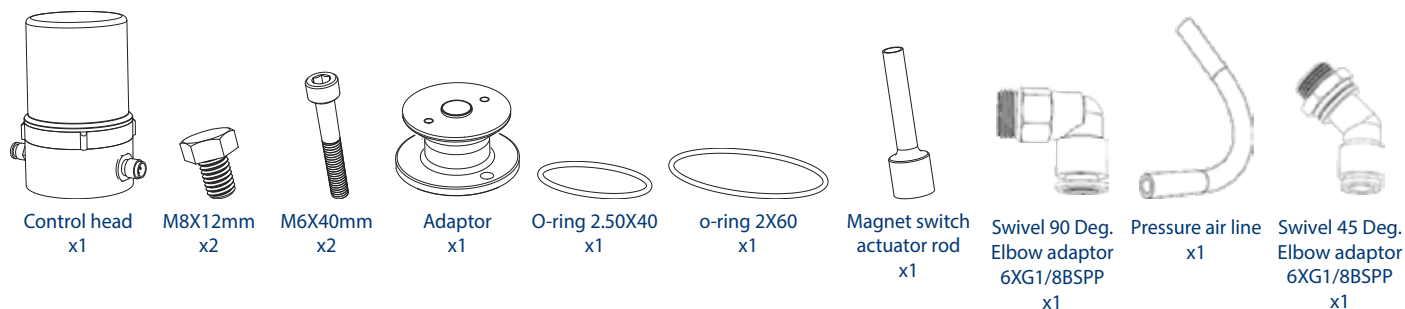

1. Unscrew main shaft cover (with slot screwdriver) and two flat head M8 screws (with Hex key #5) of the actuator's plastic cover (control head side). Remove the plastic cover

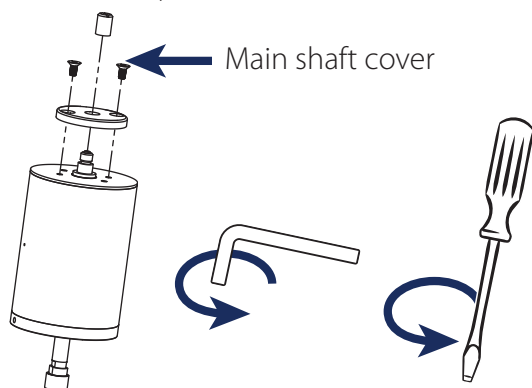

2. Insure that the plastic bushing step is forwarding the control head side.

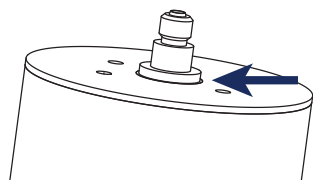

3. Unscrew manually plastic cover of control head.

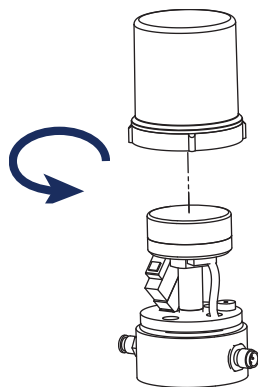

4. Insert M6 screws in control head holes.

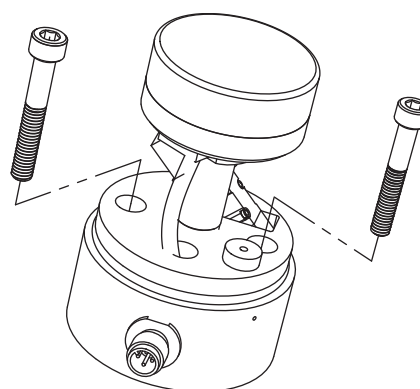

5. Screw down the two M6 screws (with Hex key #5. Closure torque $T=2.0$ [Nm] max.) through the adaptor, ensure O-ring 2x60 is in slot between control head and adaptor.

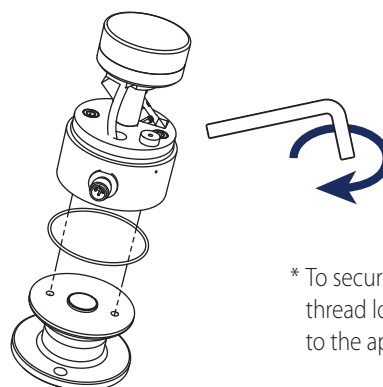

6. Screw down manually the magnet switch actuator rod to the actuator rod.

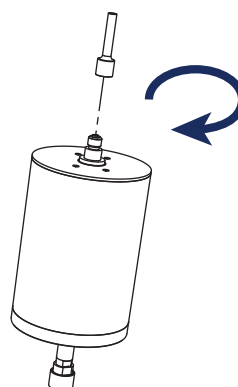

- 7.** Connect control head adaptor to the actuator with two M8 screws. Ensure O-ring 1.78x34.65 is in slot between adaptor and actuator. See configuration on section #12.

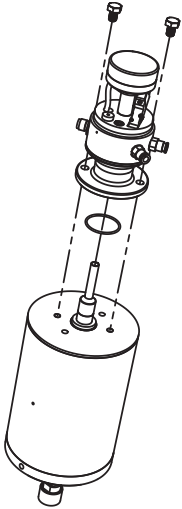

- 8.** Close the M8 screws with 13 mm Wrench Closure torque $T=4.5$ [Nm].

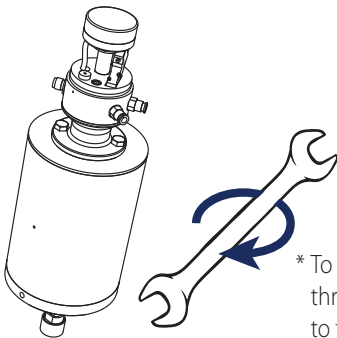

* To secure the screws use thread locker glue according to the application.

- 9.** Connect air connections and electrical connection according to configuration on section #12.
- 10.** Press control head calibration button for 3 second, until the Control Head will start automatic calibration procedure.

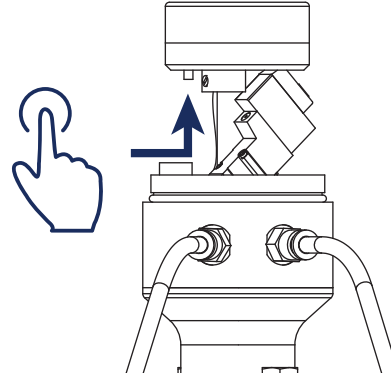

- 11.** Screw down manually the plastic cover of control head.

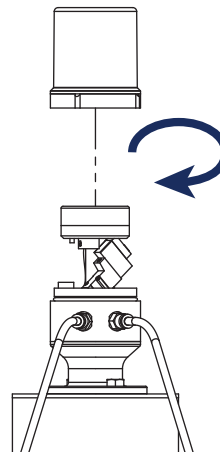

12. Connecting configurations

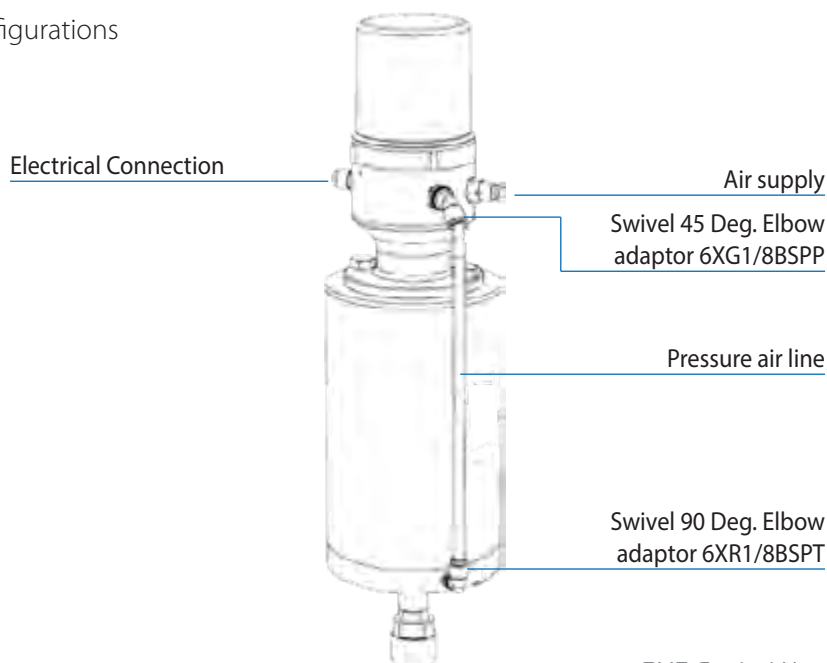

PVE 2 - NO

Parts List

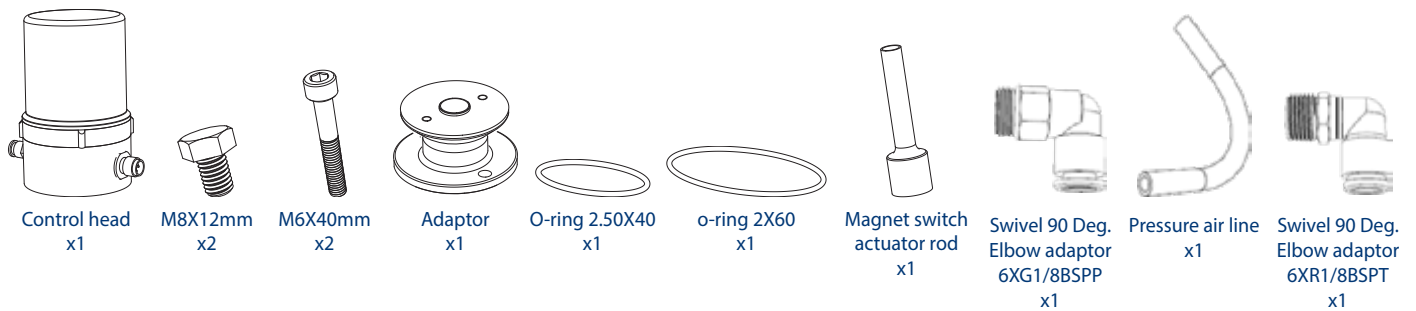

1. Unscrew main shaft cover (with slot screwdriver) and two flat head M8 screws (with Hex key #5) of the actuator's plastic cover (control head side). Remove the plastic cover

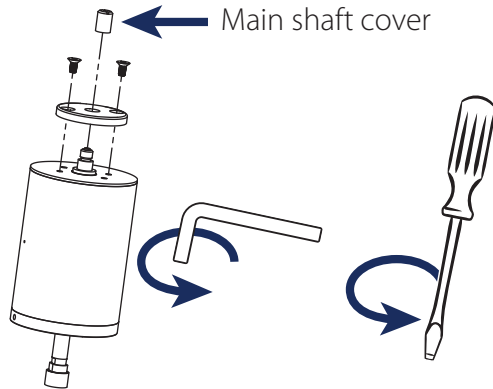

2. Insure that the plastic bushing step is forwarding the control head side.

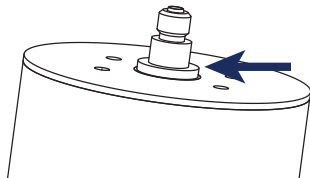

3. Unscrew manually plastic cover of control head.

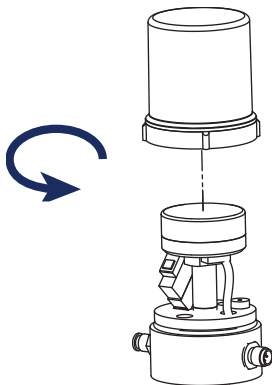

4. Insert M6 screws in control head holes.

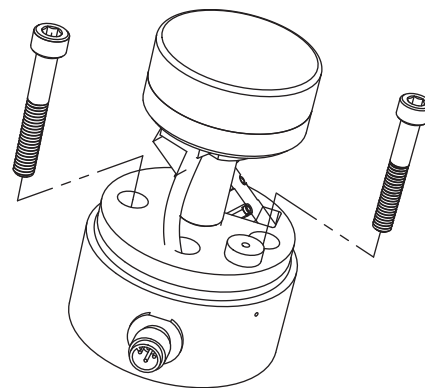

5. Screw down the two M6 screws (with Hex key #5. Closure torque $T=2.0$ [Nm] max.) through the adaptor, ensure O-ring 2x60 is in slot between control head and adaptor.



* To secure the screws use thread locker glue according to the application.

6. Screw down manually the magnet switch actuator rod to the actuator rod.

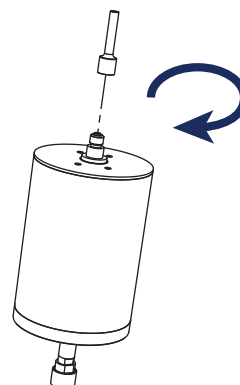

- 7.** Connect control head adaptor to the actuator with two M8 screws. Ensure O-ring 1.78x34.65 is in slot between adaptor and actuator. See configuration on section #12.

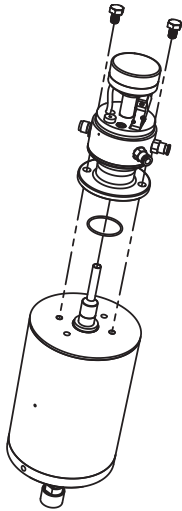

- 8.** Close the M8 screws with 13 mm Wrench Closure torque $T=4.5$ [Nm].

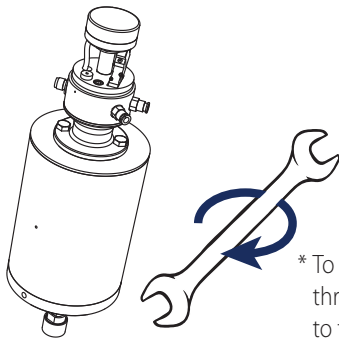

* To secure the screws use thread locker glue according to the application.

- 9.** Connect air connections and electrical connection according to configuration on section #12.
- 10.** Press control head calibration button for 3 second, until the Control Head will start automatic calibration procedure.

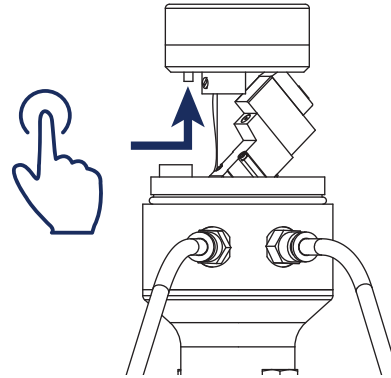

- 11.** Screw down manually the plastic cover of control head.

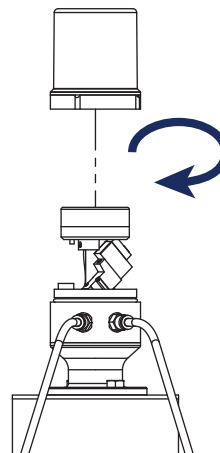

12. Connecting configurations

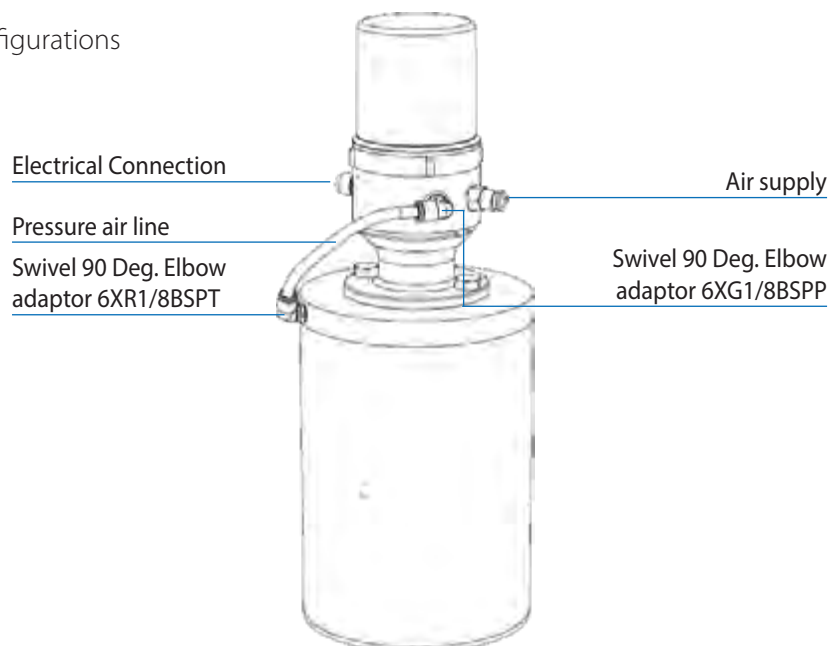

PVE 2 - NC

Parts List

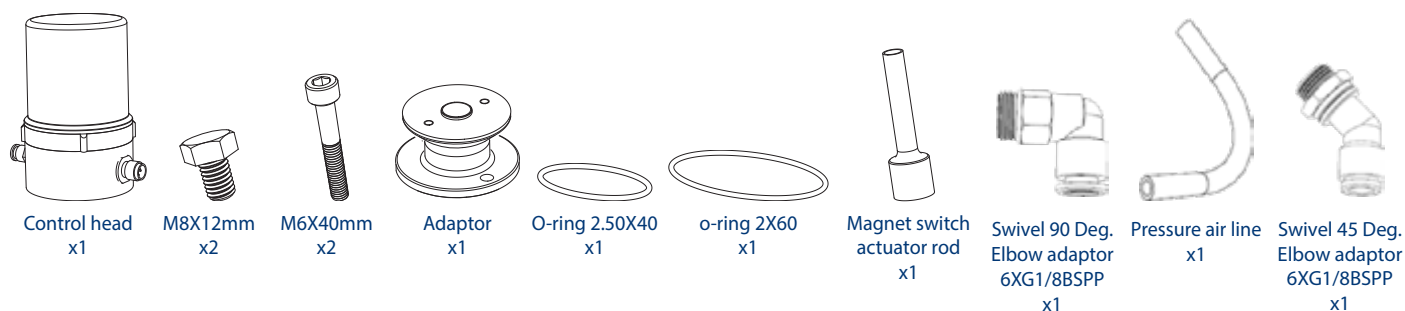

1. Unscrew main shaft cover (with slot screwdriver) and two flat head M8 screws (with Hex key #5) of the actuator's plastic cover (control head side). Remove the plastic cover

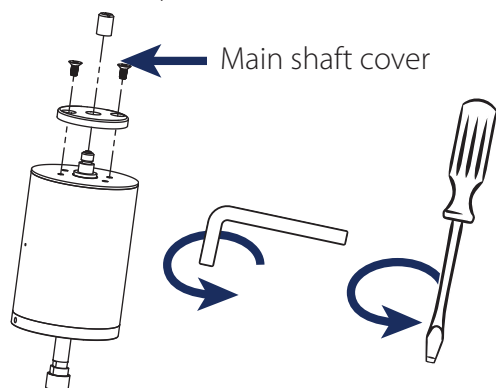

2. Insure that the plastic bushing step is forwarding the control head side.

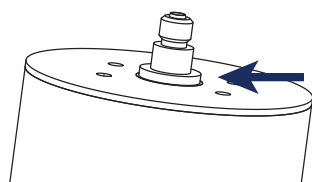

3. Unscrew manually plastic cover of control head.

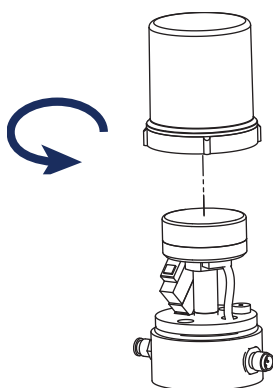

4. Insert M6 screws in control head holes.

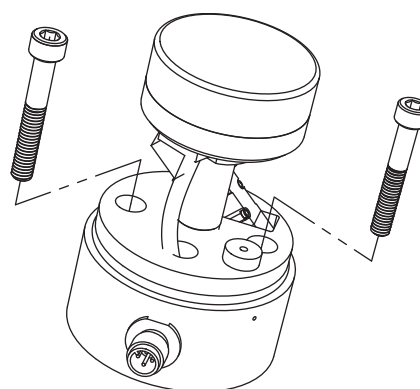

5. Screw down the two M6 screws (with Hex key #5. Closure torque $T=2.0$ [Nm] max.) through the adaptor, ensure O-ring 2x60 is in slot between control head and adaptor.

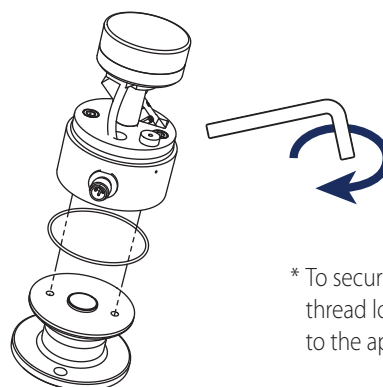

6. Screw down manually the magnet switch actuator rod to the actuator rod.

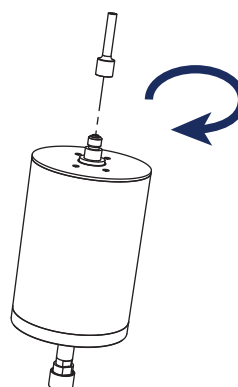

- 7.** Connect control head adaptor to the actuator with two M8 screws. Ensure O-ring 1.78x34.65 is in slot between adaptor and actuator. See configuration on section #12.

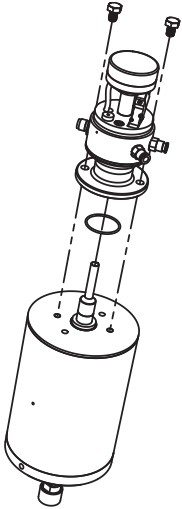

- 8.** Close the M8 screws with 13 mm Wrench Closure torque $T=4.5$ [Nm].

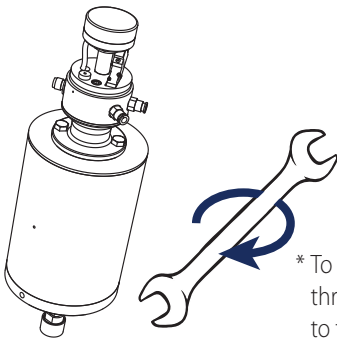

* To secure the screws use thread locker glue according to the application.

- 9.** Connect air connections and electrical connection according to configuration on section #12.
- 10.** Press control head calibration button for 3 second, until the Control Head will start automatic calibration procedure.

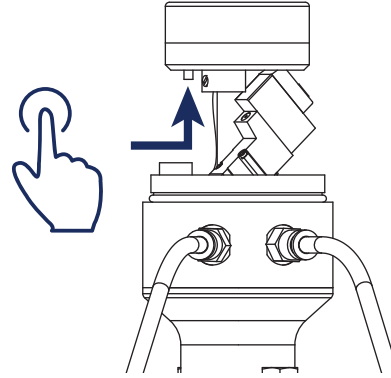

- 11.** Screw down manually the plastic cover of control head.

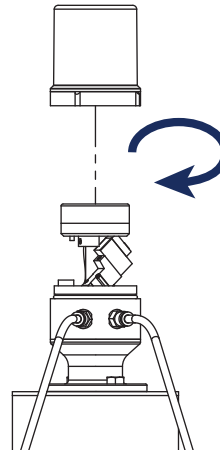

12. Connecting configurations

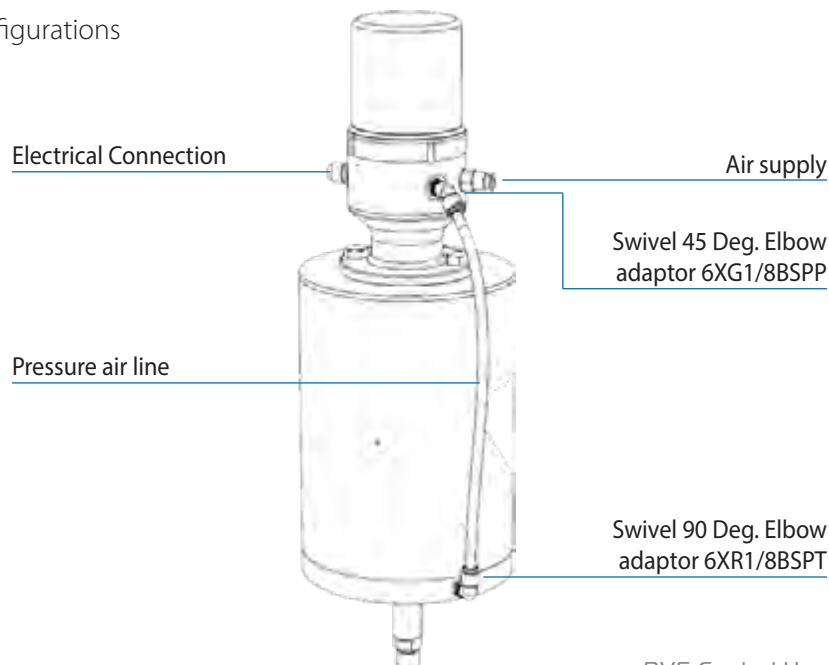

PVE 3 - NO

Parts List

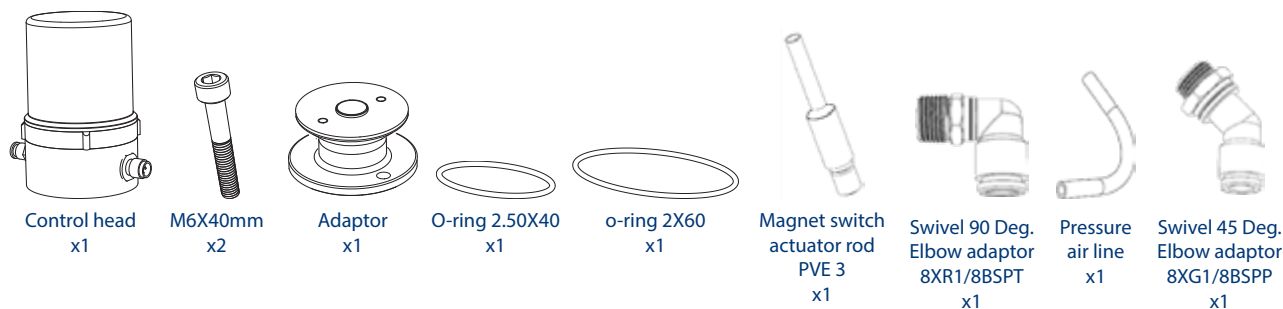

1. Unscrew main shaft cover manually and two M10 screws of the actuator's plastic cover with 17 mm wrench (control head side). Remove the plastic cover

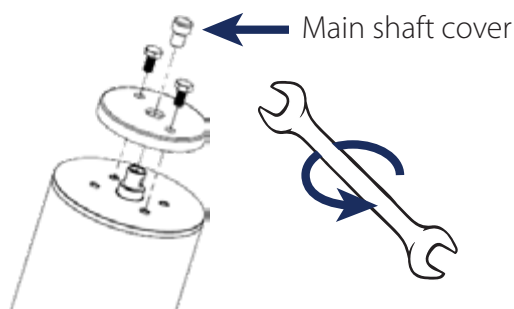

2. Insure that the plastic bushing step is forwarding the control head side.



3. Unscrew manually plastic cover of control head.

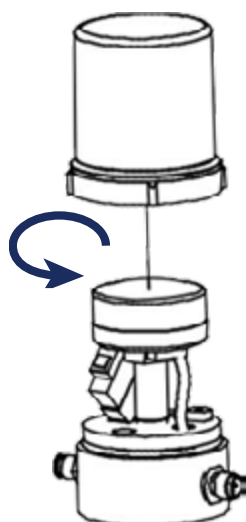

4. Insert M6 screws in control head holes.

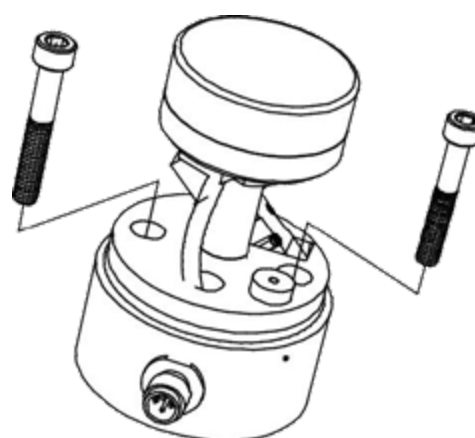

5. Screw down the two M6 screws (with Hex key #5. Closure torque $T=2.0$ [Nm] max.) through the adaptor, ensure O-ring 2x60 is in slot between control head and adaptor.



* To secure the screws use thread locker glue according to the application.

6. Screw down manually the magnet switch actuator rod to the actuator rod.

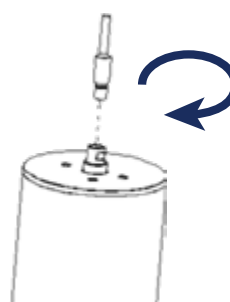

- 7.** Connect control head adaptor to the actuator with two M10 screws. Ensure O-ring 2.5x40 is in slot between adaptor and actuator. See configuration on section #12.



- 8.** Close the M10 screws with 17 mm Wrench. Closure torque $T=4.5$ [Nm].

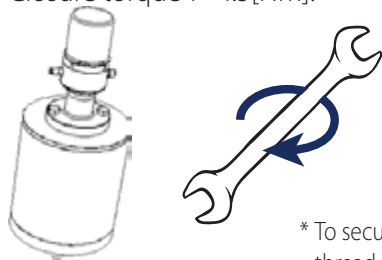

* To secure the screws use thread locker glue according to the application.

- 9.** Connect air connections and electrical connection according to configuration on section #12.

- 10.** Press control head calibration button for 3 second, until the Control Head will start automatic calibration procedure.

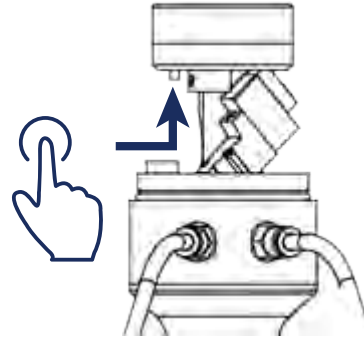

- 11.** Screw down manually the plastic cover of control head.

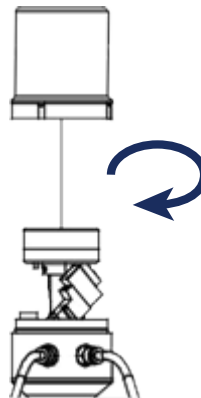

12. Connecting configurations

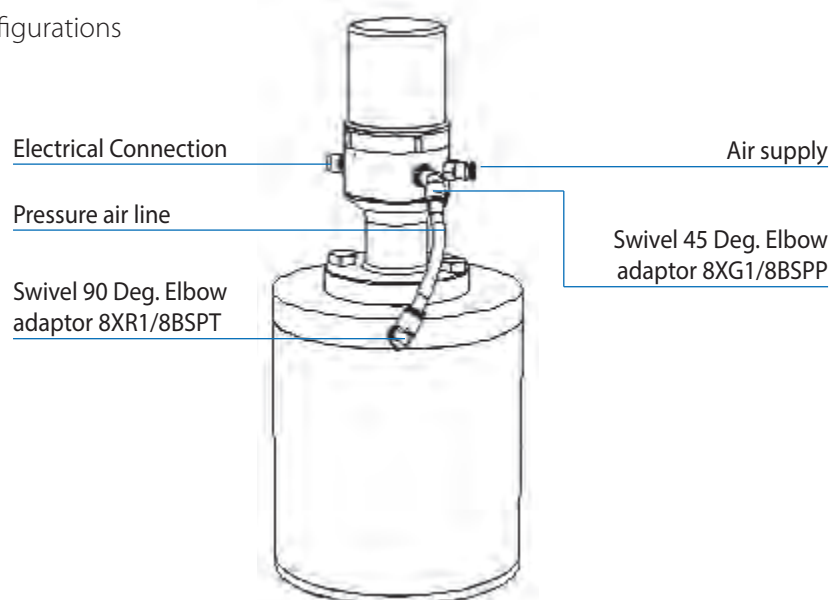

PVE 3 - NC

Parts List

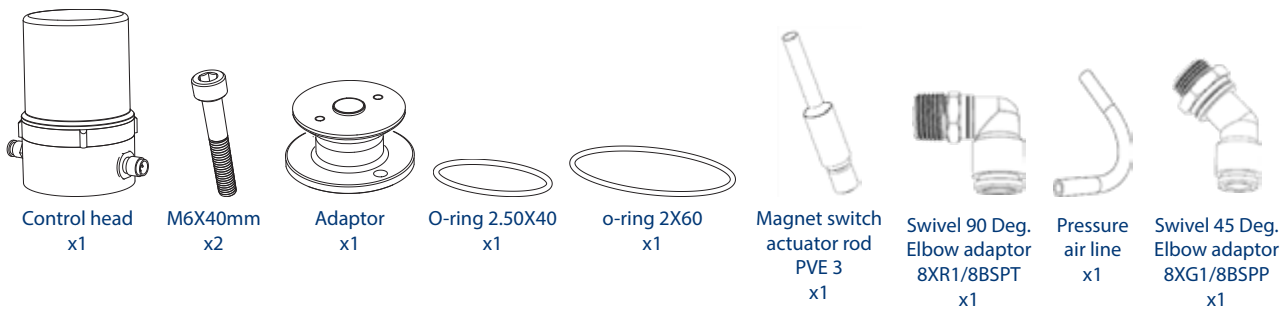

1. Unscrew main shaft cover manually and two M10 screws of the actuator's plastic cover with 17 mm wrench (control head side). Remove the plastic cover

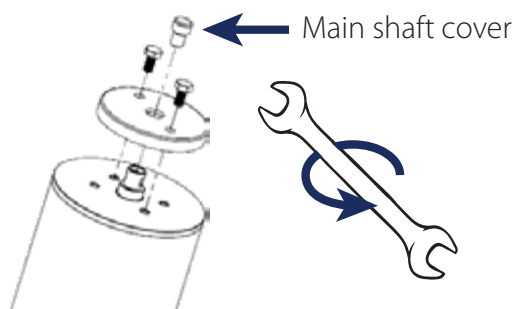

2. Insure that the plastic bushing step is forwarding the control head side.

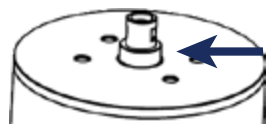

3. Unscrew manually plastic cover of control head.

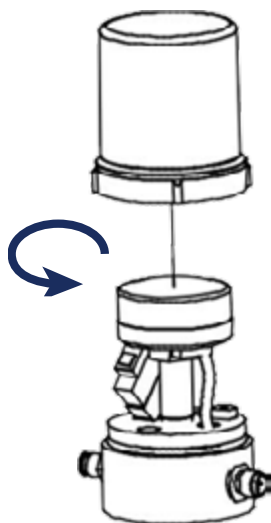

4. Insert M6 screws in control head holes.

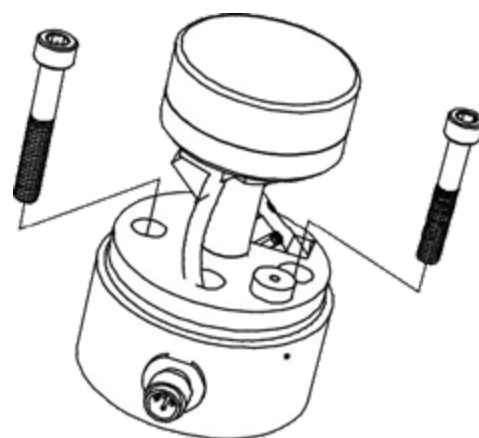

5. Screw down the two M6 screws (with Hex key #5. Closure torque $T=2.0$ [Nm] max.) through the adaptor, ensure O-ring 2x60 is in slot between control head and adaptor.

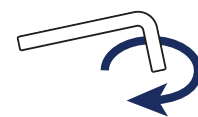

* To secure the screws use thread locker glue according to the application.

6. Screw down manually the magnet switch actuator rod to the actuator rod.

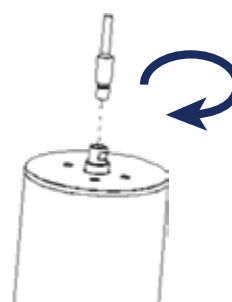

- 7.** Connect control head adaptor to the actuator with two M10 screws. Ensure O-ring 2.5x40 is in slot between adaptor and actuator. See configuration on section #12.



- 8.** Close the M10 screws with 17 mm Wrench. Closure torque $T=4.5$ [Nm].

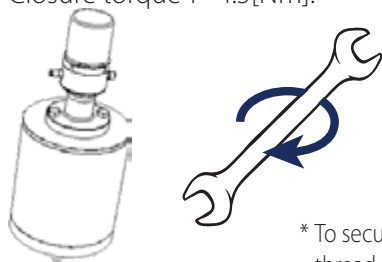

* To secure the screws use thread locker glue according to the application.

- 9.** Connect air connections and electrical connection according to configuration on section #12.

- 10.** Press control head calibration button for 3 second, until the Control Head will start automatic calibration procedure.

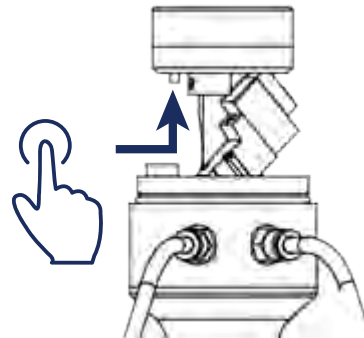

- 11.** Screw down manually the plastic cover of control head.

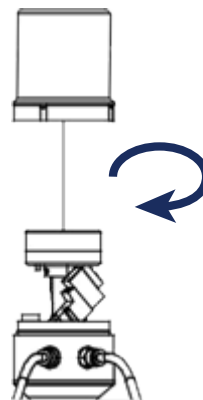

12. Connecting configurations

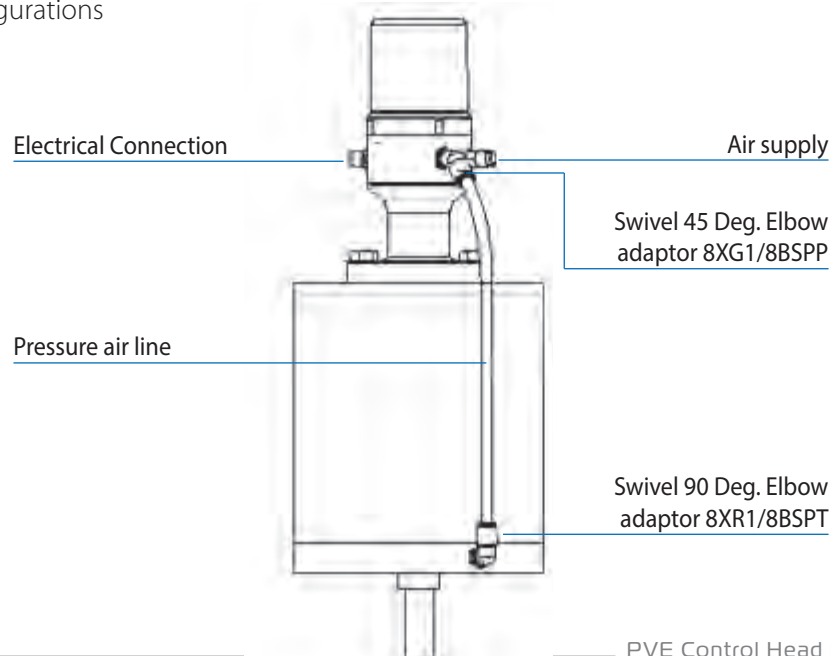

PVE Control head wire diagram

24V connection

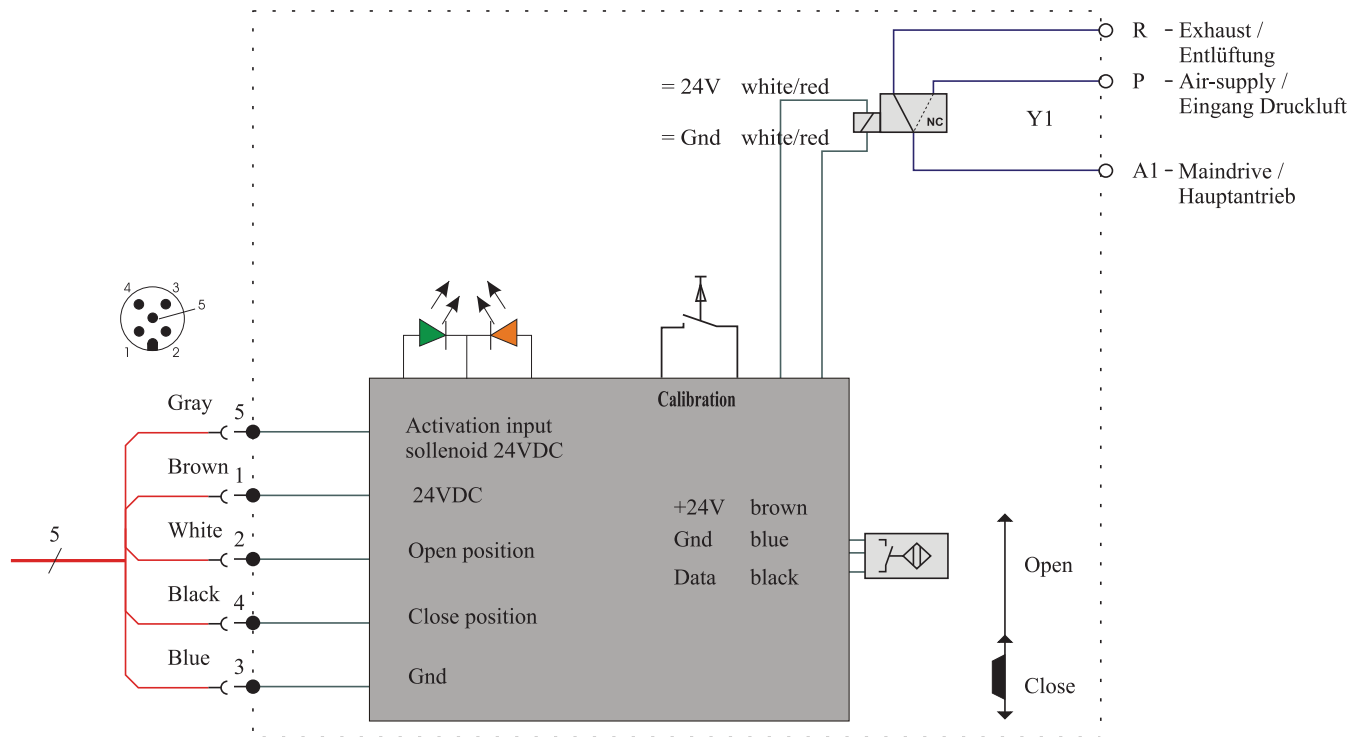

110V connection

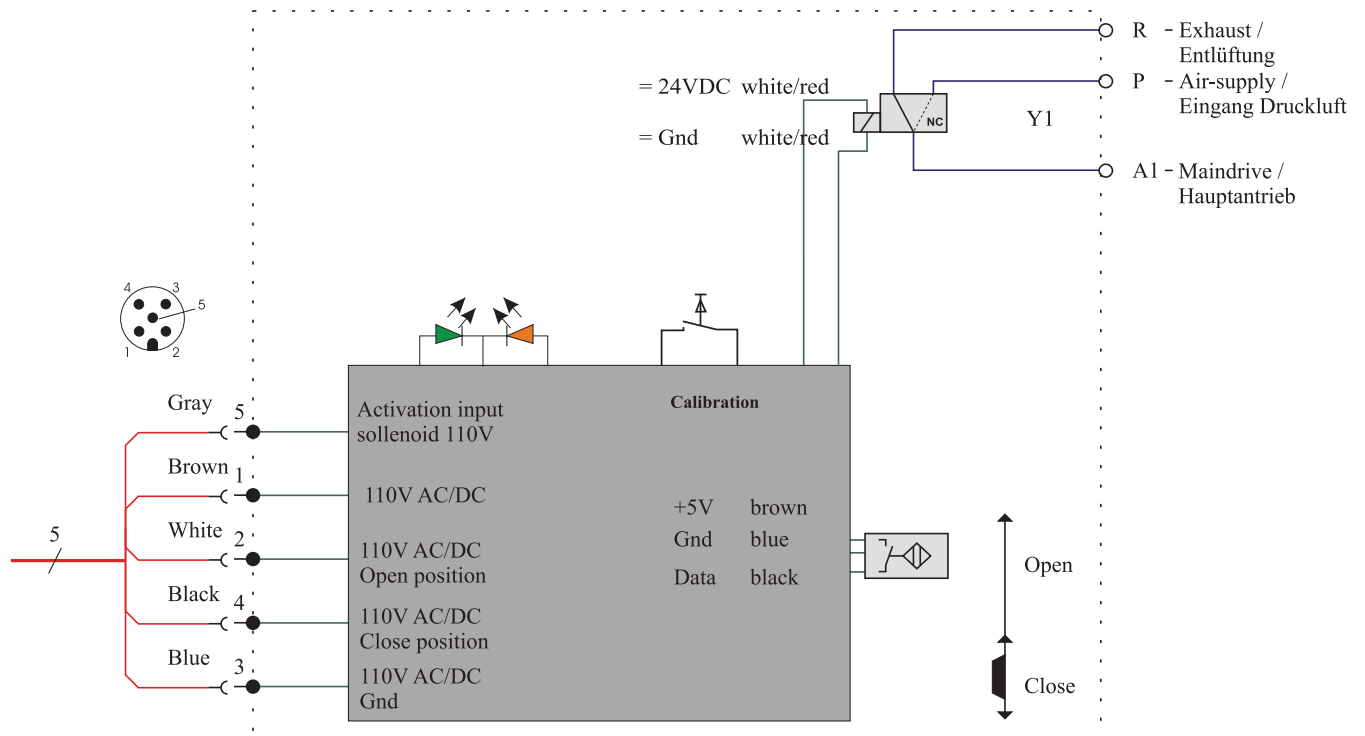

ASI connection

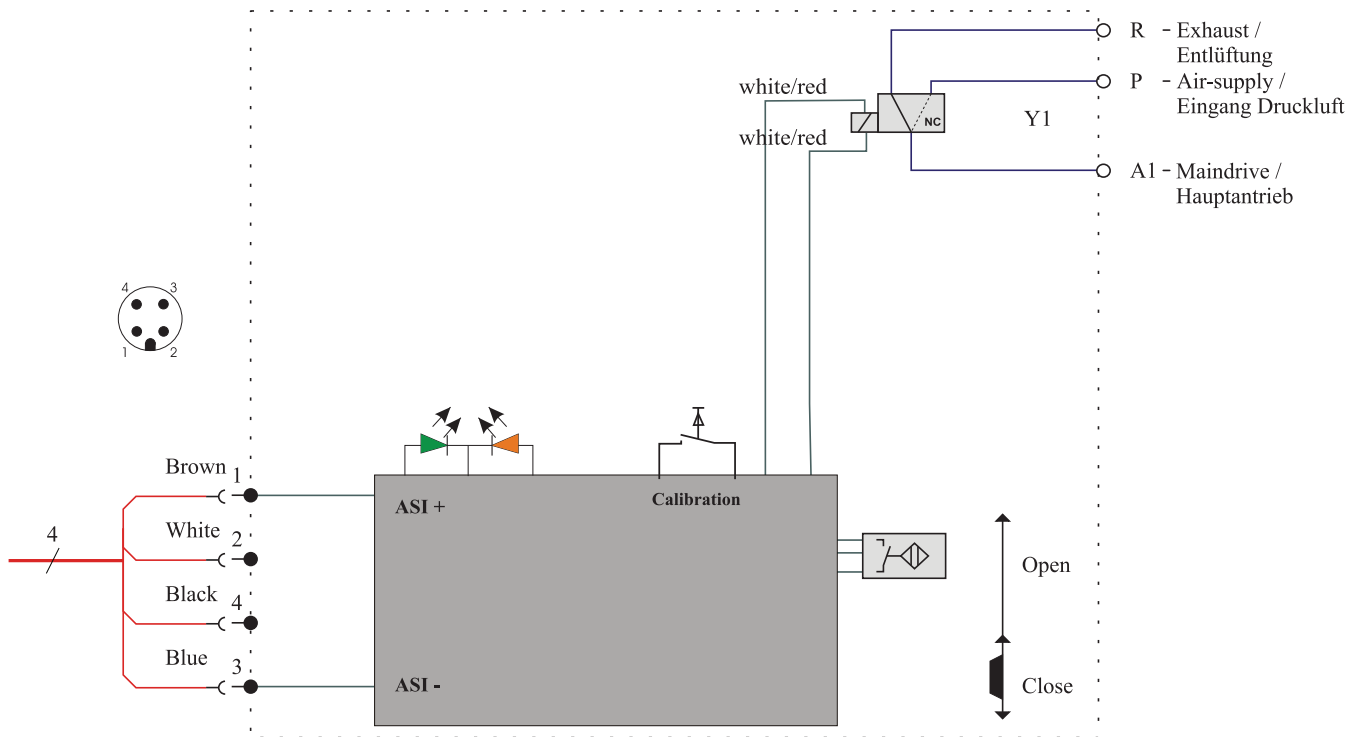

NEUMO EHRENBERG GROUP

GLOBAL LOCATIONS



NEUMO GmbH+Co. KG (D)
 Tel: +49 (0) 7043 36 0
 Fax: +49 (0) 7043 36 179
 E - Mail: info@neumo.de
www.neumo.de
GERMANY



VNE Corporation
 Tel: +1 800 356 1111
 +1 608 756 4930
 Fax: +1 608 756 3643
 E - Mail: stainless@vncorp.com
www.vnestainless.com
U.S.A



EGMO Ltd.
 Tel: +972 (0) 4 9855 176
 +972 (0) 4 9855 111
 Fax: +972 (0) 4 9855 175
 E - Mail: salese@egmo.co.il
www.egmo.co.il
ISRAEL



NEUMO - EGMO Spain S.L
 Tel: +34 977 524 914
 Fax: +34 977 524 898
 E - Mail: neumo-es@neumo-es.com
www.neumo-es.com
SPAIN



HPT Inc.
 Tel: +845.452.1103
 +800.284.4478
 E - Mail: sales@hptinc.com
<http://www.hptinc.com/>
U.S.A



Herrli AG
 Tel: +41 (0) 31 750 12 11
 Fax: +41 (0) 31 750 12 00
 E - Mail: info@herrli.net
www.herrli.net
SWITZERLAND



NEUMO Polska Sp. z.o.o
 Tel: +48 (0) 46 833 4306
 Fax: +48 (0) 46 832 5626
 E - Mail: neumo@neumo.pl
POLAND



NEUMO Turkey
 Tel: +90 (212) 875 01 41
 Fax: +90 (212) 875 23 13
 E - Mail: info@neumo.com.tr
www.neumo.com.tr
TURKEY



NEUMO Budapest Kft
 Tel: +36 (1) 3174177
 +36 (1) 3185982
 Fax: +36 (1) 266 8765
 E - Mail: neumo@neumo.hu
www.neumo.hu
HUNGARY



NEUMO LLC
 Tel: +84 908475382
 E-Mail: Minh.Vietnam@neumo.de
www.awh.eu
VIETNAM



NEUMO - VARGUS (Shanghai)
 Trading Co., Ltd
 Tel: +86 (21) 54177932
 Fax: +86 (21) 54178190
 E - Mail: info@neumo.com.cn
CHINA



NEUMO UK Ltd.
 Tel: +44 (0) 1952 583 999
 Fax: +44 (0) 1952 583 958
 E - Mail: stainless@neumo.co.uk
www.neumo.co.uk
UNITED KINGDOM



AWH Armaturenwerke (D)
 Hötensleben GmbH
 Tel: +49 (0) 39405 92 0
 Fax: +49 (0) 39405 92 111
 E - Mail: info@awh.de
www.awh.de



NEUMO
 Tel: +353 (0)21 4975540
 Cel: +353 (0)87 2330469
 E - Mail: dosullivan@neumo.de
www.neumo.de/en/
IRELAND



Damstahl a/s (Denmark)
 Tel: +45 (0) 8794 4000
 Fax: +45 (0) 8794 4150
 E - Mail: ds@damstahl.com
www.damstahl.dk
DENMARK

Damstahl GmbH (D)
 Tel: +49 (0) 2173 797 0
 Fax: +49 (0) 2173 797 274
 E - Mail: ds@damstahl.de
www.damstahl.de



Damstahl a/s Oslo (N)
 Tel: +47 5615 1570
 Fax: +47 5615 1571
 E - Mail: dano@damstahl.com
www.damstahl.no
NORWAY



Damstahl a/b (Sweden)
 Tel: +46 87 61 71 00
 Fax: +46 87 61 14 05
www.damstahl.se
SWEDEN

Gebr. Rieger GmbH+Co. KG (D)
 Tel: +49 (0) 7361 5702 0
 Fax: +49 (0) 7361 5702 51
 E - Mail: info@rr-rieger.de
www.rr-rieger.de
GERMANY



VNE
 valves products
 Scan for detail
 product info

